

# Smofcon 30 Convention Schedule

Friday, November 30-Sunday, December 2, 2012

Hyatt Regency Philadelphia at Penn's Landing

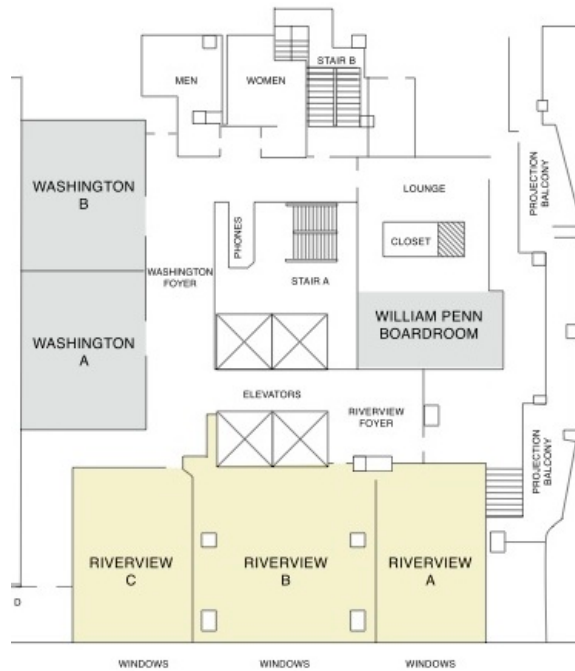

Function Space - 3rd floor

Con Suite - 21st floor

Thanks to Phoenix in 2014 NASFiC bid for a very generous donation to the Con Suite for food upgrades.

**Thursday, November 29, 2012**

**[Con Suite] Hospitality Opens at 4pm**

**[Con Suite] Philly Beer Tasting** Try some local beers *Jim Mann*

**[Con Suite] Hospitality Closed from 6-8 for dinner**

**[Con Suite] Re-opens around 8** (last person out locks up)

**[Con Suite] Pre-reg Badge Pickup** (until midnight)

**Friday, November 30, 2012**

**8:30am**

**[Con Suite] Hospitality Opens** (last person out locks up)

**10:00am**

**[Riverview C] Registration Opens** (closes at 6pm)

**12:30pm**

**[Riverview C] Coffee & Tea** Caffeine for workshop attendees

**1:00pm**

**[Washington A] Program Masterclass** Workshop required advance sign-up and is full. *Priscilla Olson (M), Ian E. Stockdale, Janice Gelb, Jim Mann, Steven H Silver*

**[Washington B] Budgeting Workshop** This workshop may have openings; stop by at 1:00pm. *Joni Brill Dashoff (M), Robert Macintosh*

**3:00pm**

**[Riverview B] Drupal ConReg - An Integrated Approach to Online Member Registration** What are the advantages of fully integrating the convention registration process with Drupal, a Website content management system? *James Shields*

**3:30pm**

**[Riverview A] Enjoying Your First Smofcon** This isn't your typical convention. Stop by and ask the members of the Pan-Pennsylvania (+Ben) Smofcon committee anything. *Laurie Mann (M), Joni Brill Dashoff, Todd Dashoff, Ben Yalow, Ann Marie Rudolph*

**4:00pm**

**[Riverview A] Planning Across Divisions** One of the major challenges every large convention has is cross-divisional coordination. How do you approach this? How do you decide priorities? When does the con chair need to step in to mediate disputes? *Deb Geisler (M), Terry Fong, Mark Olson, Ian E. Stockdale, Peggy Rae Sapienza*

**[Riverview B] Communicating with Program Participants**, Good Guests of Honors and Program participants can really help a convention soar. How do you establish open communications with Program participants? What are reasonable expectations? How do you decide how to put panelists on panels? *Priscilla Olson (M), Janice Gelb, Parris P. McBride-Martin*

**[Washington B] The Art of a Great Con Suite** The manager of this year's well-regarded World Fantasy Con Suite leads a discussion on the philosophy of running a great con suite. *Tammy Coxen*

**5:00pm**

**[Riverview A] Discussing Difficult Issues Calmly** Fandom seems to have more contentious issues than ever - harassment, Worldcon bidding, codes of conduct. How can we approach these difficult issues to generate more light and less heat? *John Pomeranz (M), Bobbi Armbruster, Ian E. Stockdale, Patty Wells, John Sapienza*

**[Riverview B] Part I: Developing Restaurant and Local Guides: Getting Ready to Research** An introduction to the Friday Night Activity-Exploring Philadelphia. What kind of assumptions do local guide developers make when they're setting up local guides? What kind of information are out-of-towners looking for? What are some unique places to go to in Philadelphia? *Stephen H. Segal (M), James Stanley Daugherty, Stacey, Kristyn Souder*

**[Washington A] Managing E-mail Lists** An E-mail list can be an extremely effective tool for managing intra-group communications...or...it can be a mess of in-fighting. What are the best tools for managing E-mail? Or do you give up and just moderate everything? *Sharon Sbarsky, Glenn Glazer*

**6:00pm**

**[Riverview B] Exploring Philadelphia** Meet-up with fen to eat, drink and visit Philadelphia! A trip to City Tavern & a pub crawl are planned - what would you like to see?

**8:00pm**

**[Con Suite] Detroit in 2014 Cocktail Hour** The Detroit NASFiC bid will tempt you with some cocktails. *Tammy Coxen*

**9:00pm**

**[Con Suite] Danny Lieberman's Memorial Cake** Come and share a piece of cake and reminisce about our friend Danny.

**[Con Suite] Registration** (open until midnight)

**Confluence, July 19-21, 2013, Pittsburgh, PA**

**GoH: Bill Keith Featured Filker: Brooke Lunderville**

<http://www.parsec-sff.org/confluence/>

**Saturday, December 1**

**8:30am**

**[Con Suite] Hospitality Opens** (last person out locks up)

**9:00am**

**[Con Suite] Spokane in 2015 Breakfast**

**9:30am**

**[Riverview C] Coffee and Tea**

**10:00am**

**[Riverview A] Part II: Developing Restaurant and Local Guides: What Did We Learn?** You've seen Philadelphia - what would you want to share with other people? What surprised you? How do you take this information and create a useful restaurant/local guide? *Anthony Lewis (M), Marah Searle-Kovacevic, Michael Nelson, Tanya Washburn, Scott Dennis*

**[Riverview B] Understanding Skill Sets and Jobs** To understand a job, it's helpful to break it down into its atomic parts - the areas of responsibility, the reporting structure, the types of tasks the person doing the job must complete. *Laurie Mann (M), Laura Domitz, Margene Bahm, Michael Lee, Peggy Rae Sapienza*

**[Washington A] Part I: Building a Convention Website with Drupal - The Basics** What is a Content Management System (CMS)? What are the advantages over traditional Websites? We then look at the background of Drupal and its modules, and then set it up on a Webserver and create a simple convention Website and add some simple Webpages. *James Shields*

**11:00am**

**[Riverview A] Preventing Con Crud** It's common for illnesses to sweep through cons. How to help prevent fen from getting sick, with emphasis on food prep & handling. *Stacey (M), MrShirt, Sara Paul*  
**Riverview B Evaluating Yourself: What Jobs Are You Best For?** What do you like to do? What do you see yourself doing? Honestly now. How you can prepare for jobs you aren't entirely up to speed on? *Patty Wells (M), Maurine Starkey, Barry Haldiman, Lynn E. Cohen Koehler, Mary Kay Kare*

**[Washington A] Part II: Building a Convention Website with Drupal - Making It Look Good** How do you create custom content types

using Drupal? We look at ways of presenting content with views. We round off with an introduction to Drupal themes and customizing the site appearance. *James Shields*

### Noon

**[Riverview A] Maintaining SF Con Culture** What makes SF cons special? What can we do to keep it? What should we try to change about SF cons? *Warren Buff (M), Priscilla Olson, Diane Lacey, Anthony Lewis, Ann Marie Rudolph*

**[Riverview B] Evaluating Others: How Do You Decide Who Does What?** One of the hardest jobs in convention-running is deciding who gets what job. It boils down to understanding the job and understanding the people who want the job. So how do you choose?

*Mark Olson (M), Terry Fong, Jeff Orth, Deb Geisler, Patty Wells*

**[Washington A] Part III: Building a Convention Website with Drupal - Enhancing Member Functionality** How do we enhance user functionality? We look at Drupal users and groups, access control, and adding member-only features such as forums, wikis, and surveys. We will also look at other modules that can be used to enhance a convention Website. *James Shields*

### 1:00pm

**[Riverview C] Lunch** Hotel buffet available for full members.

Black Angus, Chickpea & Black Bean Chili

Chicken & Apple Sausage with Caramelized Onions

Beef Burger Slider w/Cumin-Scented Cheese & Smoked Paprika Aioli

Sage-Dusted Amish Turkey Slider w/Fresh Cranberry Relish

Sweet Potato Fries with w/Aioli

Salad, Hummus, Selection of Sodas & Juice

### 2:00pm

**[Riverview ABC] The Fine Art of Firing and Quitting** Firing and quitting are two sides of the same coin - either people realizing they cannot complete a job, or other people realizing a particular person was a bad fit and can't finish it. It's an awkward situation all the way around. If you have to fire yourself or someone else, how do you do it? *Vincent Docherty (M), John Lorentz, Laurie Mann, Bruce Farr, Peggy Rae Sapienza*

**[Washington B] Creating Engaging Kids Activities** Worldcon Kids Activities have exploded into a number of wild and crazy events. How can we keep coming up with new ideas for kids? What's a good way

to scale down some of them so they'd fit better in a regional?

*Lisa Hertel (M), Lynn E. Cohen Koehler*

### 3:00pm

**[Riverview ABC] Inventing New Kinds of Programming, Events & Exhibits** It's surprising how long conventions can go without adding new kinds of things. A talk by people who invented Stroll with the Stars, Kaffeeklatches, a musical con and more! Brainstorm some new ideas that conventions can steal...err...use in the future. *Priscilla Olson (M), Tammy Coxen, Edie Stern, Vincent Docherty, Stu Segal*

### 4:00pm

**[Riverview ABC] Fannish Inquisition: Seated Worldcons & Smofcon Bids** 5 min presentations / 10 min Q&A for the '13&'14 Worldcons, 2014 Eurocon, 2013 Smofcon bid presentation/vote (~10 min - vote ~4:40) 3 min presentations by Smofcon bids for 2014 & beyond. *Helen Montgomery (M), Bill Parker, Laura Domitz, Stephen Cooper, Stephen Boucher, Deb Geisler, Alice Lawson*

### 5:00pm

**[Con Suite] Helsinki in 2015 Cocktail Hour** The Helsinki bid will mix you a drink! *Eemeli Aro, Ruth Lichtwardt*

### 8:00pm

**[Riverview ABC] Fannish Inquisition: Worldcon & NASFiC Bids** Rules of Engagement - 3 min presentations by 2014 NASFiC Bids/ 2015 Worldcon Bids (~20 min), 2 min presentations by 2016 - 2020 Worldcon bids/all Hoax bids (~15-20 min), 5 min for audience to write and submit additional questions, 5 min for Inquisitors to review and incorporate questions, Inquisition (30+ minutes - until end of allotted session time / run out of questions) *Helen Montgomery (M), Stephen Boucher, Deb Geisler*

## Sunday, December 2

### 8:30am

**[Con Suite] Hospitality Opens** (last person out locks up)

### 9:00am

**[Con Suite] Orlando in 2015 Breakfast**

9:30am

**[Riverview C] Coffee and Tea**

10:00am

**[Riverview A] How to Talk to Tech** What can conventions do to improve communications with the tech crew? And what can the tech crew do to make these communications run more smoothly? *Warren Buff (M), Bill Parker, David Henkin, Peter Olszowka, Chuck Shimada*

**[Riverview B] Managing a Fan Table** Beyond flyers and fanbait, what else do you need to promote your con, your bid, your club? Re-envision it as a dynamic marketing device. *Dina Krause (M), Sharon Sbarsky, Marah Searle-Kovacevic, Glenn Glazer, Cathy Green*

11:00am

**[Con Suite] Lunch and Snacks** We'll even have lunch bags to go!

**[Riverview A] Understanding the Different Issues of Genre Cons (Philcon/Boskone...) and "Sub-Genre" Cons (Anthrocon/ Costumecon/Anime Cons...)** Lit Cons, Anime, Furry Cons...how are these different? How are they the same? And what about that 500 pound elephant in the room - San Diego Comic Con? *David Henkin (M), Carl Fink, Douglas Muth (Giza), Adam Beaton, Mary Dumas*

**[Riverview B] When the Chair Is the Problem** A chair should lead...or guide the committee to pull together and run a good convention. But, what happens when the chair is getting in the way of getting the job done? Do you work around the chair...or replace him (or her)? *Peggy Rae Sapienza (M), John Lorentz, Vincent Docherty*

Noon

**[Riverview A] Electronic Site Selection** Electronic Hugo voting has helped more people to vote. Can electronic site selection bring in more voters? What are some of the issues behind implementing electronic site selection? *Joni Brill Dashoff (M), Eemeli Aro, Saul Jaffe, Steven Staton, Ben Yalow*

**[Riverview B] Different Registration Prices for Different Groups** Conventions often have sliding membership rates depending on when people buy them. Are there other ways to charge people for memberships? *Todd Dashoff (M), Michael Loreda*

**[Riverview C] Worldcon/NASFiC Poster Session** Upcoming Worldcon & NASFiC bids will set up "poster sessions" and will be available to answer additional questions on their bids.

1:00pm

**[Riverview A] Closing Down a Worldcon - Disbursements & Paperwork** What are the steps in closing down a Worldcon? How does

a committee decide how to make disbursements...or settle debts if there are insufficient funds? *Ben Yalow (M), Dave McCarty, John Pomeranz, Joni Brill Dashoff, Kent Bloom*

**[Riverview B] Rethinking Worldcon Bidding** How can we take Worldcon bidding beyond parties, flyers and bid tables? *Margene Bahm (M), Eemeli Aro, Eva Whitley, Helen Montgomery*

2:00pm

**[Riverview A] Changing Convention Art Shows** What can we do to attract artists to Art Shows? What kinds of changes do we need to make to the Art Show? *Gay Ellen Dennett (M), Shirley Avery, Andrea Senchy, Jannie Shea, Martin Deutsch*

**[Riverview B] Con Access and Universal Design** How can we improve the layout of cons to make it easier for handicapped fans? *Bobbi Armbruster, Tanya Washburn, Bill Thomasson, Becky Thomson*

**[Washington A] Parliamentary Procedure & You**, Review of the basics of *Roberts Rules of Order*, and how to use it. *Ben Yalow (M), Mark W. Richards, Kent Bloom*

3:00pm

**[Riverview A] Ethics and the SF Community** Harassment, codes of conduct, backlash...are fans becoming less ethical, or are many more sensitive? *Peggy Rae Sapienza (M), Carl Fink, Suford Lewis, Farah Mendlesohn*

**[Riverview B] How to Attract and Manage Volunteers and How to Keep Them Happy** You've figured out the jobs and recruited people. Congratulations! Now, how do you keep them happy? How do you keep the communication lines open? *Mary Kay Kare (M), Glug, Melanie Herz, Sharon Pierce*

4:00pm

**[Riverview A] The "Same People Paradox"-Keep the Same Job or Take Different Jobs?** When people do the same job year after year, they get experience and there's usually area continuity...but, often there's a resistance to change. When people do different jobs, they get a breadth of experience in different areas...but don't always handle new jobs very smoothly. *Stephen Boucher (M), Maurine Starkey, Rick Kovalcik, Farah Mendlesohn, Syd Weinstein*

**[Riverview B] When Facilities Go Wrong** Chicon 7 had some significant drama with its hotel this past year. Come, grasshoppers, and learn the lessons from their experience. You'll laugh, you'll cry, you'll gasp in horror, and you'll be awed by the fact that Chicon actually happened. *Bobbi Armbruster (M), Dave McCarty, Bruce Farr, Steven H Silver, Helen Montgomery*